

SDN SERIES DIAL SNAP GAGE

This rugged snap gage features a precision box-way range adjustment channel to protect the anvil shafts and maximize frame clearance.

FEATURES:

- 090° gaging travel is standard, optional with .500".
- Precision box way slide allows 1" of range adjustment.
- Rugged frame is machined from 5/8" thick aluminum jig plate.
- 5/8" solid carbide lapped anvils with generous lead radius.
- Anvils are flat and parallel within .00015" on frame sizes below 4", within .0002" on 4"-8" frames, .00025" on 8-12" frames and within .0003" above 12".
- Heat insulating impact resistant handles.
- Adjustable nylon backstop protects parts.
- Collet mounted indicator can be rotated to suit application.
- May be used with any Dorsey "High Amplification", "Traditional" or digital indicators.

RANGE		FLAT 5/8" SQ. ANVILS	
		2I50-01	WITHOUT INDICATOR
INCH	METRIC	.0001" GRAD MULTI REV.	
0 - 1"	0 - 25mm	SDN-00	SDN-00NI
1 - 2"	25 - 51mm	SDN-100	SDN-100NI
2 - 3"	51 - 76mm	SDN-200	SDN-200NI
3 - 4"	76 - 102mm	SDN-300	SDN-300NI
4 - 5"	102 - 127mm	SDN-400	SDN-400NI
5 - 6"	127 - 152mm	SDN-500	SDN-500NI
6 - 7"	152 - 178mm	SDN-600	SDN-600NI
7 - 8"	178 - 203mm	SDN-700	SDN-700NI
8 - 9"	203 - 229mm	SDN-800	SDN-800NI
9 - 10"	229 - 254mm	SDN-900	SDN-900NI
10 - 11"	254 - 279mm	SDN-1000	SDN-1000NI
11 - 12"	279 - 305mm	SDN-1100	SDN-1100NI
12 - 13"	305 - 330mm	SDN-1200	SDN-1200NI
13 - 14"	330 - 356mm	SDN-1300	SDN-1300NI
14 - 15"	356 - 381mm	SDN-1400	SDN-1400NI
15 - 16"	381 - 406mm	SDN-1500	SDN-1500NI
16 - 17"	406 - 432mm	SDN-1600	SDN-1600NI
17 - 18"	432 - 458mm	SDN-1700	SDN-1700NI
18 - 19"	458 - 483mm	SDN-1800	SDN-1800NI
19 - 20"	483 - 508mm	SDN-1900	SDN-1900NI
20 - 21"	508 - 533mm	SDN-2000	SDN-2000NI
21 - 22"	533 - 559mm	SDN-2100	SDN-2100NI
22 - 23"	559 - 584mm	SDN-2200	SDN-2200NI
23 - 24"	584 - 610mm	SDN-2300	SDN-2300NI
48502-S		BENCH STAND	



SDN-700 snap gage

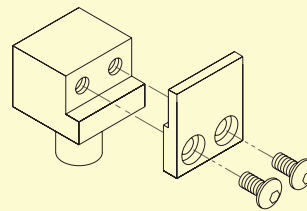

Blade type anvil
Special sizes available

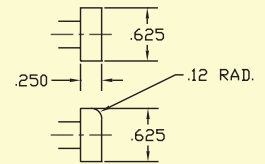

Part #209
Standard carbide anvil

OPTIONAL CONTACT TRAVEL	OPTIONAL BLADE ANVILS	LIFTING LEVER	SIDE STOPS
To specify extended gaging contact travel, add "TXX" to end of part number. -T100 = .100" Travel -T500 = .500" Travel Standard with Lifting Lever (-L)	To specify blade anvils, add "-BXXX" to end of part number. Blade sizes: -B40 = .040" Wide x .08 tall -B60 = .060" Wide x .12 tall -B80 = .080" Wide x .16 tall -B100 = .100" Wide x .20 tall -B125 = .125" Wide x .31 tall -B156 = .156" Wide x .31 tall -B187 = .187" Wide x .31 tall	To specify a lifting lever, add "-L" to end of part number.	To specify side stops, add "SS" to end of part number. Note: Side stops are made to order.

Part # sequence: Snap gage part #, Contact travel, Blade anvil, Lifting lever, Side stops

Proudly made in the USA 