

		mm	in
00730043	TESA-HITE 400	415	16
00730044	TESA-HITE 700	715	28
CONSISTING OF:		400	700
00760143	Standard probe insert holder	●	●
00760157	Rechargeable battery, 6V	●	●
00760219	Master piece for establishing the probe constant, nominal dimension to 6,350 mm / 0.250 in	●	●
00760226	Electric pump for creating the air-cushion beneath the gauge base, already mounted	●	●
00760227	Standard probe insert with shank and 5 mm dia. ball tip in tungsten carbide	●	●
04761054	Mains adapter 100 ÷ 200 VAC / 50 ÷ 60 Hz	●	●
04761055	Cable EU for mains adapter	●	●
04761056	Cable US for mains adapter	●	●
OPTIONAL ACCESSORIES:			
04761052	Extension cable, Sub-D 9p/f to 9p/m, 2 m		
04761063	Sub-D 9p/m to USB cable, 2 m		
04760070	RS port, used to connect a digital sensor for perpendicularity measurement		

- Linear expansion $(12 \pm 1,5) \times 10^{-6} K^{-1}$
- IP40, electronics to IP65 (IEC 60529)
- SCS calibration certificate

Technical data

	Models	TESA-HITE 400	TESA-HITE 700
		415	715
		16	28
	With standard accessory	mm 0 ÷ 570	mm 0 ÷ 870
		in 0 ÷ 22	in 0 ÷ 34
	With probe insert holder No. 00760057	mm 0 ÷ 625	mm 0 ÷ 925
		in 0 ÷ 24	in 0 ÷ 36
	With probe insert holder No. S07001622	mm 0 ÷ 795	mm 0 ÷ 1095
		in 0 ÷ 31	in 0 ÷ 43
	With standard accessory	$(2,5 + 4 L) \mu m$ (L in m)	
		$(0.0001 + 0.000004 L)$ in (L in in)	
	With standard accessory	On flat surfaces: $2\sigma < 2 \mu m / < 0.0001$ in	
		Into bores: $2\sigma < 3 \mu m / < 0.00015$ in	
	Frontal, mechanical	μm 9	μm 13
		in 0.00035	in 0.0005
		kg 27	kg 32

Standard Accessories

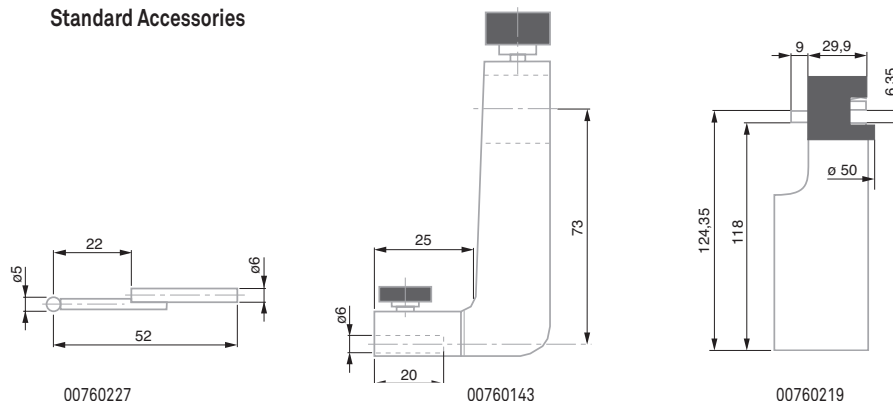

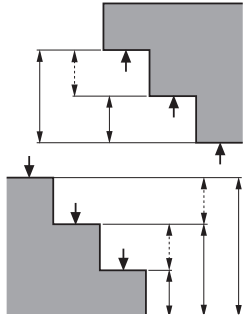

One-dimensional measurement

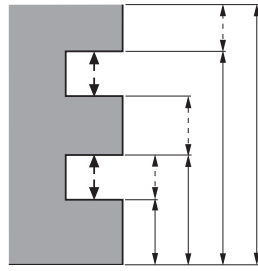

One-dimensional measurement

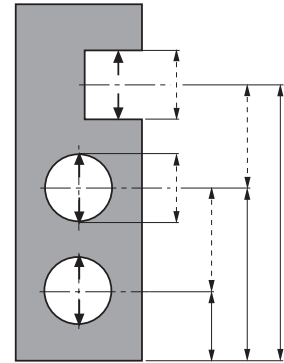

One-dimensional measurement

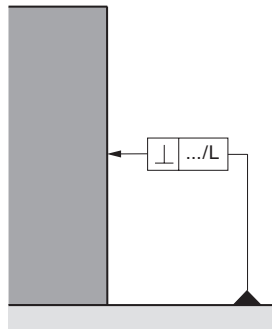

Perpendicularity measurement

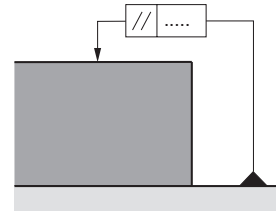

Parallelism measurement



Squareness verification with inductive probe and TWIN-T10 display

