

## DORSEY STANDARD BORE GAGES

### A TIME PROVEN DESIGN MADE BETTER BY DORSEY

This design of rugged production line bore gages has been an industry standard for more than 75 years. Dorsey offers precise replacement models built to the same exacting specifications but, with a choice of any of Dorsey's "High Amplification", "Traditional" or digital indicators. We continue to provide the original Standard Gage Company® customers with high quality interchangeable parts. We also build bore gages with modifications, special gages and new models to meet their current and future needs.

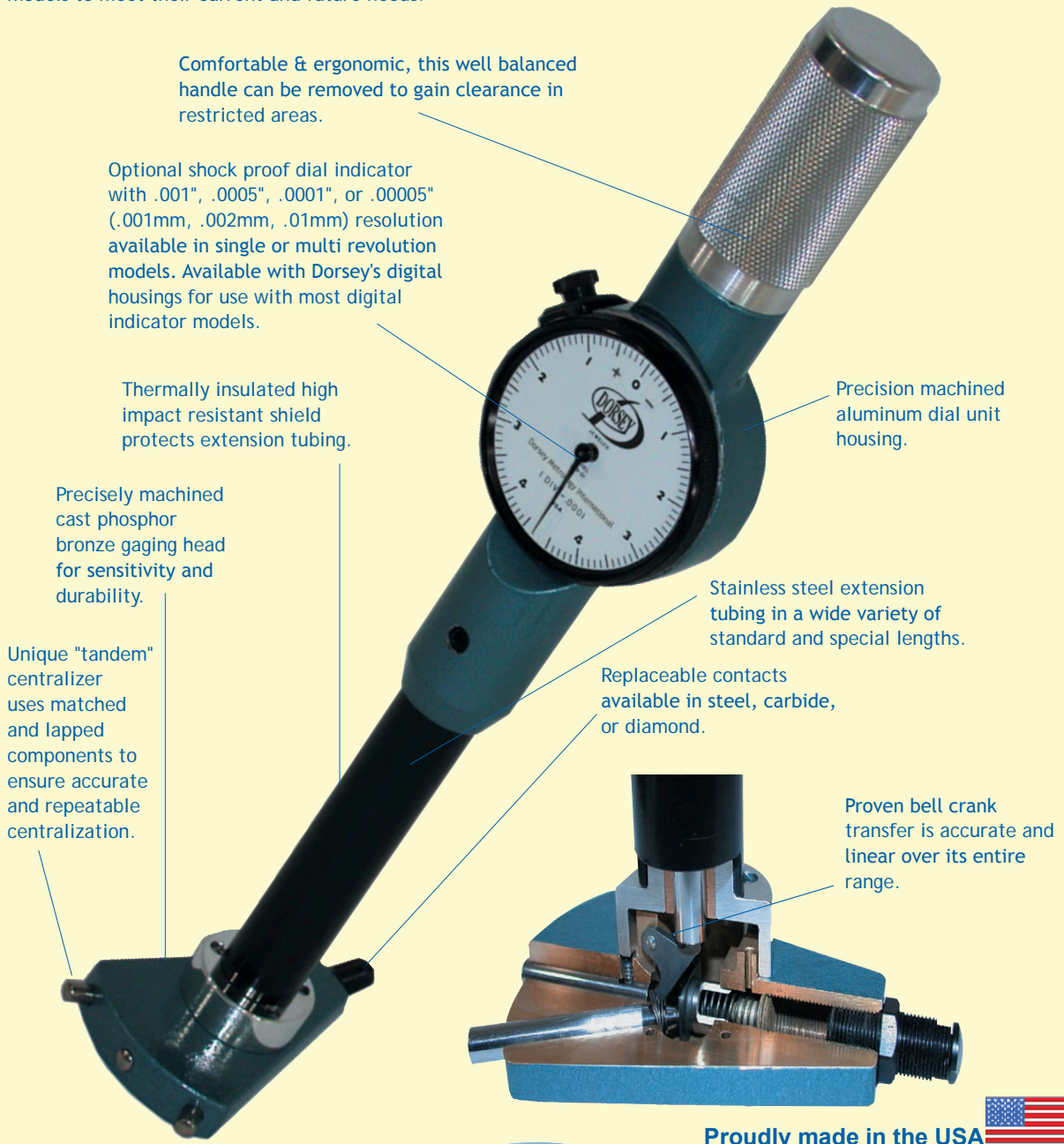

Comfortable & ergonomic, this well balanced handle can be removed to gain clearance in restricted areas.

Optional shock proof dial indicator with .001", .0005", .0001", or .00005" (.001mm, .002mm, .01mm) resolution available in single or multi revolution models. Available with Dorsey's digital housings for use with most digital indicator models.

Thermally insulated high impact resistant shield protects extension tubing.

Precisely machined cast phosphor bronze gaging head for sensitivity and durability.

Unique "tandem" centralizer uses matched and lapped components to ensure accurate and repeatable centralization.

Precision machined aluminum dial unit housing.

Stainless steel extension tubing in a wide variety of standard and special lengths.

Replaceable contacts available in steel, carbide, or diamond.

Proven bell crank transfer is accurate and linear over its entire range.

Proudly made in the USA



# DORSEY STANDARD BORE GAGES

## A TIME PROVEN DESIGN MADE BETTER BY DORSEY

This design of rugged production line bore gages has been an industry standard for more than 75 years. Dorsey offers precise replacement models built to the same exacting specifications but, with a choice of any of Dorsey's "High Amplification", "Traditional" or digital indicators. We continue to provide the original Standard Gage Company® customers with high quality interchangeable parts. We also build modifications and special gage models.

**STYLE 1** - All sizes utilize the same dial unit housing for extreme versatility

Size 3  
1.50"-2.16"  
38.1 - 54.864mm

Size 4  
2.12"-3.13"  
53.848 - 79.502mm

Size 5  
3.09"-6.13"  
78.486 - 155.702mm

Size 6  
6.00"-12.13"  
152.4 - 308.102mm

Size 2  
1.00"-1.53"  
25.4 - 38.862mm



Proudly made in the USA 

# DORSEY STANDARD LARGE BORE GAGES

## A TIME PROVEN DESIGN EXPANDED TO MEASURE LARGE BORE SIZES

**Style 1** - Both models utilize the same robust 1" heavy duty dial unit housing with a choice of various resolutions and spindle travel in both inch or metric readings (see catalog pages A-10 - A-11).

\*Both the #7 and #8 bore gages measure .625" from the bottom of a blind bore.

\*The standard gaging depth is 6" but can be supplied with depth extensions to 144".

\*Besides these large bore gages, we also offer two companion bore gage setting masters that are set to size with gage block combinations. Setmaster # DBM-12000 (12"-24") and # DBM-24000 (20" to 36") are adjustable, more convenient to handle and less expensive than a library of traditional large rings.

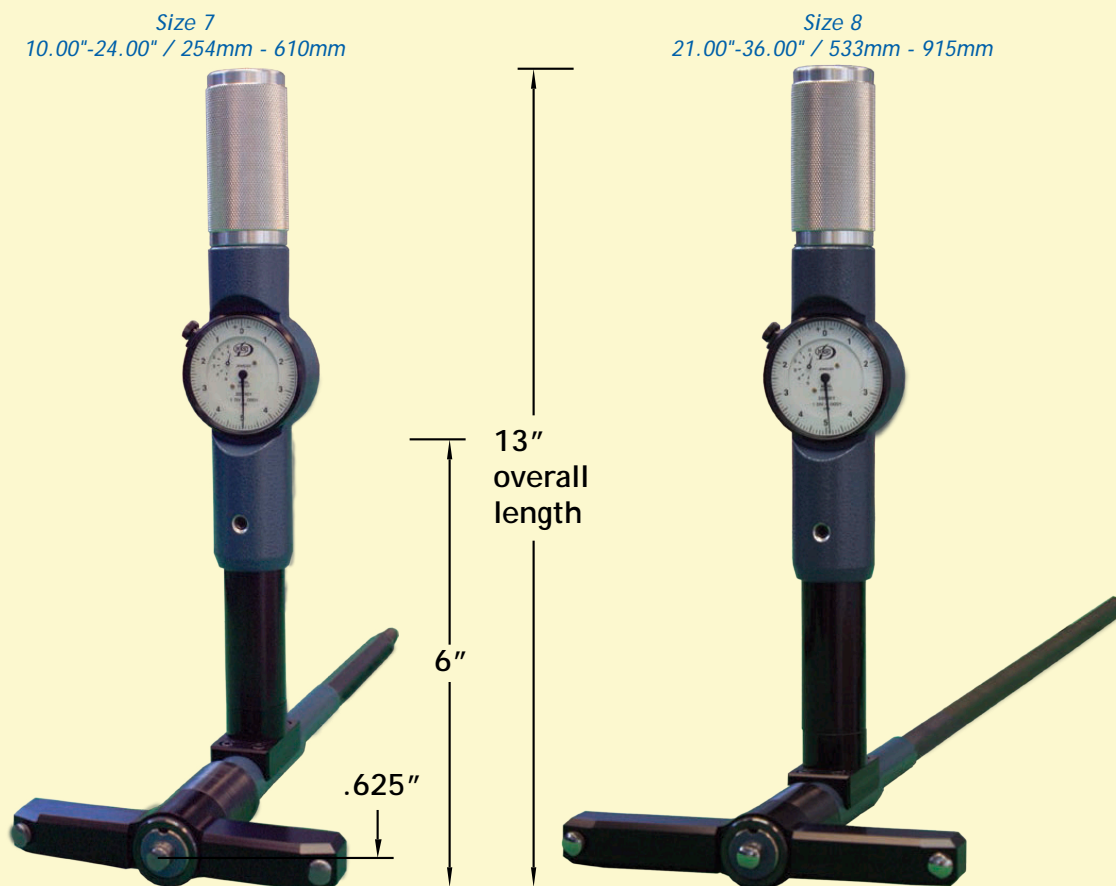

### OPTIONAL: BORE GAGE DEPTH EXTENSIONS

4" DEPTH EXTENSION	12" DEPTH EXTENSION	36" DEPTH EXTENSION
5" DEPTH EXTENSION	14" DEPTH EXTENSION	Other Lengths Available
6" DEPTH EXTENSION	16" DEPTH EXTENSION	37-72"
8" DEPTH EXTENSION	24" DEPTH EXTENSION	72-144"
10" DEPTH EXTENSION	30" DEPTH EXTENSION	



# DORSEY STANDARD BORE GAGES

There are 5 optional styles that are designed especially for applications where space restrictions or gaging positions are not suitable to the use of the Style 1.

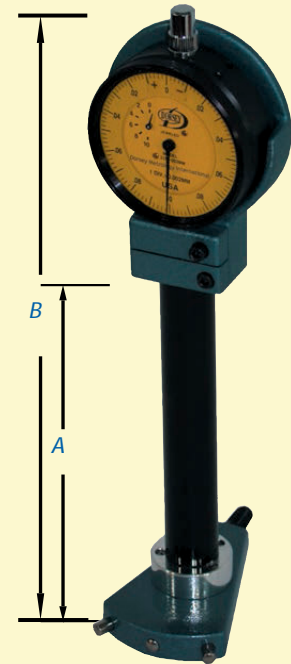
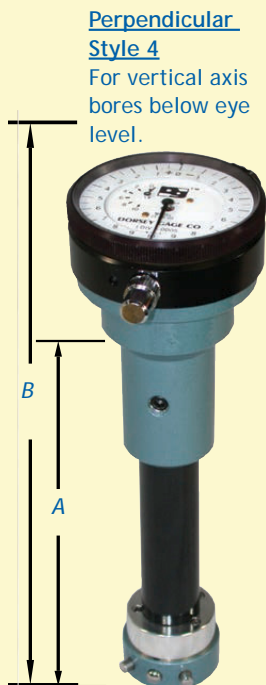
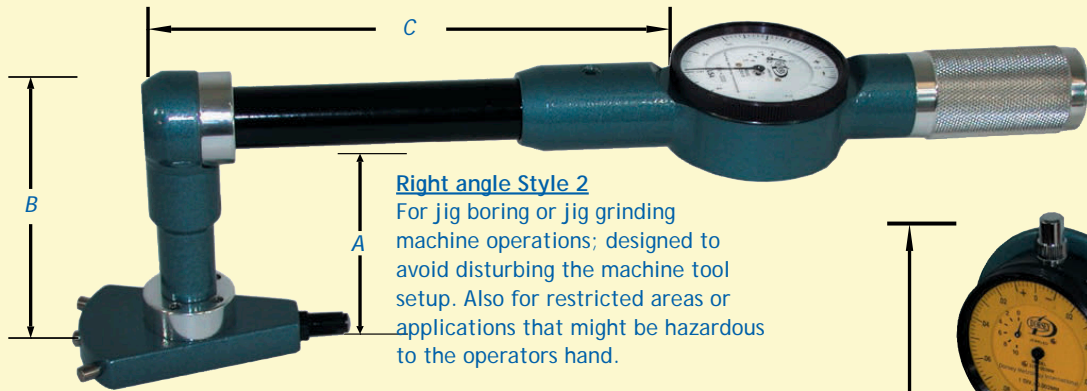

# DORSEY STANDARD BORE GAGES

GAGE SIZE	STANDARD STYLE 1			RIGHT ANGLE STYLE 2				VERTICAL STYLE 3			PERPENDICULAR STYLE 4		PISTOL GRIP STYLE 5		FLUSH STYLE 7		
	A		B	A		B	C	A		B	A		B	A	B	B	
	STD	MIN		STD	MIN			STD	MIN		STD	MIN		STD	MIN		
2	5.00"	2.31"	8.12"	2.53"	2.35"	3.88"	6.25"	6.0"	2.31"	8.75"	6.0"	2.31"	8.13"	1.63"	1.63"	5.75"	-
3	5.00"	2.63"	10.50"	2.53"	2.35"	3.88"	6.25"	6.0"	2.63"	9.0"	6.0"	2.63"	8.13"	1.63"	1.63"	5.75"	-
4	5.00"	2.63"	10.50"	2.53"	2.35"	3.88"	6.25"	6.0"	2.63"	9.00"	6.0"	2.63"	8.13"	1.63"	1.63"	5.75"	-
5	6.00"	2.63"	11.50"	2.53"	2.35"	3.83"	6.25"	6.0"	2.63"	9.00"	6.0"	2.63"	8.13"	1.63"	1.63"	5.75"	-
6	6.00"	2.63"	12.00"	2.50"	2.50"	4.44"	6.69"	6.0"	5.50"	9.44"	6.0"	4.00"	8.13"	3.00"	3.00"	9.38"	1.50"

Note: Additional range ext. up to 20" available for #6

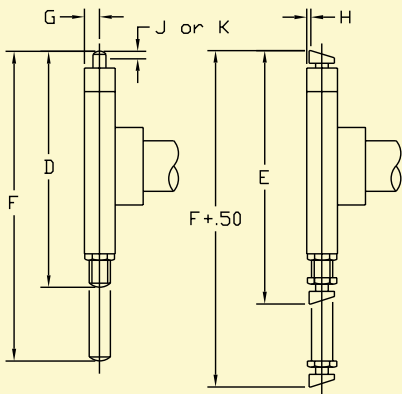

## GAGE-HEAD DIMENSIONS (ALL STYLES)

SIZE	D		E		F	G	H	J	K	RANGE EXTENSION ADAPTER PART #
	MIN	MAX	MIN	MAX						
2	1.00"	1.53"	1.19"	1.69"	1.75"	.195"	.140"	.025"	.050"	DS-B0-85929
3	1.5"	2.16"	1.69"	2.56"	3.13"	.224"	.156"	.025"	.050"	DS-B0-85934
4	2.12"	3.13"	2.56"	3.56"	4.00"	.224"	.032"	.025"	.075"	DS-B0-85942
5	3.09"	6.13"	3.50"	6.44"	8.00"	.224"	.032"	.025"	.075"	DS-B0-85952
6	6.00"	12.13"	6.44"	12.63"	20"	.312"	.032"	.030"	.100"	DS-B0-85967

- D = Standard gaging range
- E = Gaging range with optional offset contacts
- F = Maximum gaging range with extension adapters
- G = Standard center line
- H = Offset center line modification add -H to part #
- J = Standard gaging plunger travel
- K = Optional extended plunger travel add -K to part #

## BORE GAGE EXTENSION HOUSING #3, 4 & 5

EXTENSION HOUSING ASSEMBLY	
PART #	DESCRIPTION
DX2-8100503	3" "A" LENGTH EXTENSION
DX2-8100504	4" "A" LENGTH EXTENSION
DX2-8100505	5" "A" LENGTH EXTENSION
DX2-8100506	6" "A" LENGTH EXTENSION
DX2-8100508	8" "A" LENGTH EXTENSION
DX2-8100510	10" "A" LENGTH EXTENSION
DX2-8100512	12" "A" LENGTH EXTENSION
DX2-8100514	14" "A" LENGTH EXTENSION
DX2-8100516	16" "A" LENGTH EXTENSION
DX2-8100518	18" "A" LENGTH EXTENSION
DX2-8100524	24" "A" LENGTH EXTENSION
DX2-8100530	30" "A" LENGTH EXTENSION
DX2-8100536	36" "A" LENGTH EXTENSION
Other Lengths Available	
	37-71"
	72-144"



## CONTACT MATERIALS

Steel (Standard), tungsten carbide, or diamond are supplied in the following quantities unless otherwise specified

- Size 2, 3, 4, or 5
- 1 gaging plunger
- 2 centralizing plungers (diamond not available)
- 1 interchangeable reference contact
- Size 6
- 4 interchangeable contacts

Note: Materials may be specified intermixed

## BORE GAGE DUST CAP:

- Replaces standard handle.
- Minimize overall length ("B" dimension).

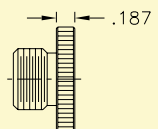

SIZE	REDUCES "B" DIM. BY	PART #
2-6	2.06"	DS-B0-84725
6 Heavy Duty	2.81"	DS-B0-84731

Proudly made in the USA

# DIAL BORE GAGE COMBINATION KIT

## Models 2,3,4,5

### FEATURES:

- Industry's most popular dial bore gage now available in an easy-to-use combination kit.
- Standard with jeweled shock proof indicator movement.
- Available with a wide variety of indicators including .00005" or 0.001mm.
- Replaces separate dial bore gages covering the same ranges as models # 2, 3, 4, and 5.
- Considerable cost savings.
- Convenient carrying case.
- Ideal for small shops or short production runs.
- Interchangeable gage heads and range extensions to cover diameters from 1.000" to 8.000" or 25mm to 200mm.



PART #	DESCRIPTION
DS-B1-K2345	WITH .0001" GRAD DIAL INDICATOR
DS-B1-K2345M	WITH 0.002mm GRAD DIAL INDICATOR

## EXTRA LENGTH BORE GAGE EXTENSIONS:

- Bore gage extension housings with gaging depths up to 36" are normally manufactured from stainless steel tubing. See the price list for ordering data for each model.
- Bore gages with extra length extensions beyond 36" are available in other material options. Most long bore gages are normally produced from stainless steel tubing up to 72" depths. Traditionally, beyond this length, the #4, #5 and #6 bore gages are constructed using segmented steel tubing. All extra length bore gage tubing may also be provided with carbon fiber extensions that are lighter weight, more thermally stable and structurally stronger.

### Maximum Recommender Gaging Depths

GAGE SIZE	INCH DEPTH
SIZE #2	60" maximum
SIZE #3	72" maximum
SIZE #4	96" maximum

GAGE SIZE	INCH DEPTH
SIZE #5	144" maximum
SIZE #6	144" maximum

#6 Dorsey/Standard bore gage with 5' steel extension housing. The Weight is 7¾ lbs/3.52kg (less range extensions).



#6 Dorsey/Standard bore gage with 4' carbon fiber extension housing. The weight is 4 lbs/1.8kg (less range extensions).



#4 Dorsey/Standard bore gage with 4' carbon fiber extension housing. The weight is 2½ lbs/1.13kg (less range extensions).



Proudly made in the USA 

# DORSEY STANDARD BORE GAGES

DS- B1- 1 2 1 0 4 -12  
 Style Indicator Contacts Indicator Gage Size A Length

GAGE SIZE	INDICATOR GRADUATION	HIGH AMPLIFICATION INDICATOR	PART NUMBER	TRADITIONAL INDICATOR	TRADITIONAL PART NUMBER
1.00 - 1.53" 2 25.4 - 38.9mm	.00005 <sup>in</sup>	DS-214-005	DS-B1-10102		
	.0001 <sup>in</sup>	DS-219-01	DS-B1-11102		
	.0001 <sup>in</sup>	DS-2150-01	DS-B1-12102	DS-2DM025-01	DS-B2-12102
	.00025 <sup>in</sup>	DS-211000-025	DS-B1-10112		
	.0005 <sup>in</sup>	DS-2140-05	DS-B1-13102		
	.0005 <sup>in</sup>	DS-21100-05	DS-B1-14102	DS-2DM050-05	DS-B2-14102
	NONE	LESS INDICATING UNIT	DS-B1-15102		
	0.010mm <sup>2</sup>	DS-2110-01mm	DS-B1-16102	DS-2DM5-01mm	DS-B2-16102
	0.005mm	DS-2125-005mm	DS-B1-17102	DS-2DM012-005mm	DS-B2-17102
	0.002mm	DS-2110-002mm	DS-B1-18102	DS-2DM005-002mm	DS-B2-18102
	0.002mm <sup>2</sup>	DS-2102-002mm	DS-B1-19102		
	0.001mm <sup>2</sup>	DS-2101-001mm	DS-B1-10122		
	.0001 <sup>in</sup> / .002mm <sup>2</sup>	S2I.M	DS-B1-12102M		
.00005 <sup>in</sup> / 0.001mm	DIGITAL	DS-B5-10102			
1.50 - 2.16" 3 38.1 - 54.8mm	.00005 <sup>in</sup>	DS-214-005	DS-B1-10103		
	.0001 <sup>in</sup>	DS-219-01	DS-B1-11103		
	.0001 <sup>in</sup>	DS-2150-01	DS-B1-12103	DS-2DM025-01	DS-B2-12103
	.00025 <sup>in</sup>	DS-211000-025	DS-B1-10113		
	.0005 <sup>in</sup>	DS-2140-05	DS-B1-13103		
	.0005 <sup>in</sup>	DS-21100-05	DS-B1-14103	DS-2DM050-05	DS-B2-14103
	NONE		DS-B1-15103		
	0.010mm <sup>2</sup>	DS-2110-01mm	DS-B1-16103	DS-2DM5-01mm	DS-B2-16103
	0.005mm	DS-2125-005mm	DS-B1-17103	DS-2DM012-005mm	DS-B2-17103
	0.002mm	DS-2110-002mm	DS-B1-18103	DS-2DM005-002mm	DS-B2-18103
	0.002mm <sup>2</sup>	DS-2102-002mm	DS-B1-19103		
	0.001mm <sup>2</sup>	DS-2101-001mm	DS-B1-10123		
	.0001 <sup>in</sup> / .002mm <sup>2</sup>	S2I.M	DS-B1-12103M		
.00005 <sup>in</sup> / 0.001mm	DIGITAL	DS-B5-10103			
2.12 - 3.13" 4 54.0 - 79.5mm	.00005 <sup>in</sup>	DS-214-005	DS-B1-10104		
	.0001 <sup>in</sup>	DS-219-01	DS-B1-11104		
	.0001 <sup>in</sup>	DS-2150-01	DS-B1-12104	DS-2DM025-01	DS-B2-12104
	.00025 <sup>in</sup>	DS-211000-025	DS-B1-10114		
	.0005 <sup>in</sup>	DS-2140-05	DS-B1-13104		
	.0005 <sup>in</sup>	DS-21100-05	DS-B1-14104	DS-2DM050-05	DS-B2-14104
	NONE		DS-B1-15104		
	0.010mm <sup>2</sup>	DS-2110-01mm	DS-B1-16104	DS-2DM5-01mm	DS-B2-16104
	0.005mm	DS-2125-005mm	DS-B1-17104	DS-2DM012-005mm	DS-B2-17104
	0.002mm	DS-2110-002mm	DS-B1-18104	DS-2DM005-002mm	DS-B2-18104
	0.002mm <sup>2</sup>	DS-2102-002mm	DS-B1-19104		
	0.001mm <sup>2</sup>	DS-2110-001mm	DS-B1-10124		
	.0001 <sup>in</sup> / .002mm <sup>2</sup>	S2I.M	DS-B1-12104M		
.00005 <sup>in</sup> / 0.001mm	DIGITAL	DS-B5-10104			
3.09 - 6.13" 5 78.5 - 156mm	.00005 <sup>in</sup>	DS-214-005	DS-B1-10105		
	.0001 <sup>in</sup>	DS-219-01	DS-B1-11105		
	.0001 <sup>in</sup>	DS-2150-01	DS-B1-12105	DS-2DM025-01	DS-B2-12105
	.00025 <sup>in</sup>	DS-211000-025	DS-B1-10115		
	.0005 <sup>in</sup>	DS-2140-05	DS-B1-13105		
	.0005 <sup>in</sup>	DS-21100-05	DS-B1-14105	DS-2DM050-05	DS-B2-14105
	NONE		DS-B1-15105		
	0.010mm <sup>2</sup>	DS-2110-01mm	DS-B1-16105	DS-2DM5-01mm	DS-B2-16105
	0.005mm	DS-2125-005mm	DS-B1-17105	DS-2DM012-005mm	DS-B2-17105
	0.002mm	DS-2102-002mm	DS-B1-18105	DS-2DM005-002mm	DS-B2-18105
	0.002mm <sup>2</sup>	DS-2102-002mm	DS-B1-19105		
	0.001mm <sup>2</sup>	DS-2110-001mm	DS-B1-10125		
	.0001 <sup>in</sup> / .002mm <sup>2</sup>	S2I.M	DS-B1-12105M		
.00005 <sup>in</sup> / 0.001mm	DIGITAL	DS-B5-10105			

Proudly made in the USA



# DORSEY STANDARD LARGE BORE GAGES

DS- B1- 1 2 1 0 4 -12  
Style Indicator Contacts Indicator Gage Size A Length

GAGE SIZE	INDICATOR GRADUATION	HIGH AMPLIFICATION INDICATOR	PART NUMBER	TRADITIONAL INDICATOR	TRADITIONAL PART NUMBER
6.00 - 12.13" 6 152.5 - 308.0mm	.00005 <sup>MS</sup>	DS-214-005	DS-B1-10106		
	.0001 <sup>MS</sup>	DS-219-01	DS-B1-11106		
	.0001"	DS-2150-01	DS-B1-12106	DS-2DM025-01	DS-B2-12106
	.00025 <sup>MS</sup>	DS-211000-025	DS-B1-10116		
	.0005 <sup>MS</sup>	DS-2140-05	DS-B1-13106		
	.0005"	DS-21100-05	DS-B1-14106	DS-2DM050-05	DS-B2-14106
	NONE		DS-B1-15106		
	0.010mm <sup>2</sup>	DS-2110-01mm	DS-B1-16106	DS-2DM5-01mm	DS-B2-16106
	0.005mm	DS-2125-005mm	DS-B1-17106	DS-2DM012-005mm	DS-B2-17106
	0.002mm	DS-2110-002mm	DS-B1-18106	DS-2DM005-002mm	DS-B2-18106
	0.002mm <sup>2</sup>	DS-2102-002mm	DS-B1-19106		
	0.001mm <sup>2</sup>	DS-2101-001mm	DS-B1-10126		
	.0001" / .00005 <sup>MS</sup>	S2I.M	DS-B1-12106M		
.00005" / 0.001mm	DIGITAL	DS-B5-10106		T	
10.00 - 24.00" 7 254 - 610mm	.00005 <sup>MS</sup>	DS-214-005	DS-B1-10107		
	.0001 <sup>MS</sup>	DS-219-01	DS-B1-11107		
	.0001"	DS-2150-01	DS-B1-12107	DS-2DM025-01	DS-B2-12107
	.00025 <sup>MS</sup>	DS-211000-025	DS-B1-10117		
	.0005 <sup>MS</sup>	DS-2140-05	DS-B1-13107		
	.0005"	DS-21100-05	DS-B1-14107	DS-2DM050-05	DS-B2-14107
	NONE	LESS INDICATING UNIT	DS-B1-15107		
	0.010mm	DS-2110-01mm	DS-B1-16107	DS-2DM5-01mm	DS-B2-16107
	0.005mm	DS-2125-005mm	DS-B1-17107	DS-2DM012-005mm	DS-B2-17107
	0.002mm	DS-2110-002mm	DS-B1-18107	DS-2DM005-002mm	DS-B2-18107
	0.002mm	DS-2102-002mm	DS-B1-19107		
	0.001mm	DS-2101-001mm	DS-B1-10127		
	.0001" / .002mm	S2I.M	DS-B1-12107M		
.00005" / 0.001mm	DIGITAL	DS-B5-10107			
21.00 - 36.00" 8 533 - 915mm	.00005 <sup>MS</sup>	DS-214-005	DS-B1-10108		
	.0001 <sup>MS</sup>	DS-219-01	DS-B1-11108		
	.0001"	DS-2150-01	DS-B1-12108	DS-2DM025-01	DS-B2-12108
	.00025 <sup>MS</sup>	DS-211000-025	DS-B1-10118		
	.0005 <sup>MS</sup>	DS-2140-05	DS-B1-13108		
	.0005"	DS-21100-05	DS-B1-14108	DS-2DM050-05	DS-B2-14108
	NONE		DS-B1-15108		
	0.010mm	DS-2110-01mm	DS-B1-16108	DS-2DM5-01mm	DS-B2-16108
	0.005mm	DS-2125-005mm	DS-B1-17108	DS-2DM012-005mm	DS-B2-17108
	0.002mm	DS-2110-002mm	DS-B1-18108	DS-2DM005-002mm	DS-B2-18108
	0.002mm	DS-2102-002mm	DS-B1-19108		
	0.001mm	DS-2101-001mm	DS-B1-10128		
	.0001" / .002mm	S2I.M	DS-B1-12108M		
.00005" / 0.001mm	DIGITAL	DS-B5-10108			

## WOOD STORAGE BOX



PART #	GAGE SIZE
DX2-89952	2
DX2-89953	3
DX2-89954	4
DX2-89955	5
DX2-89956	6
DX2-89927	COMBINATION KIT

DS Series bore gages are shipped in disposable shipping containers. To order a fitted wooden storage box see the chart.

## FEATURES:

- Additional range ext up to 36". See Pricelist.
- All models come with steel contacts but carbide and diamond contacts are also available.

Proudly made in the USA 