

Digital Indicators 1075 R

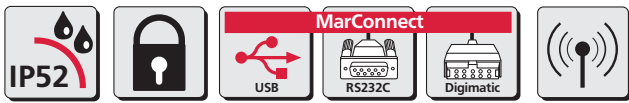

REFERENCE



Features

- Functions:**
 ON/OFF
 RESET (Set display to zero)
 mm/inch
 Reversal of counting direction
 PRESET (for entering a numerical value)
 DATA (data transmission with a data connection cable)
 LOCK-Function: Individual buttons can be locked
 Auto-OFF (selectable)
- Immediate measurement due to the Reference system
 - Operating time approx. 3 years (2000 work. h/year)
 - Max measuring speed 1.5 m/sec (60"/sec)
 - MarConnect Data output: choose either
 USB
 OPTO RS232C
 Digimatic
 - High contrast Liquid Crystal Display with 12 mm high digits
 - Operating temperature 10-40°C
 - Class of protection IP52 according to IEC 60529
- Scope of supply:
 Battery,
 Operating instructions

Reference System - Just set once to zero

REFERENCE The new Digital Indicators 1075 R are equipped with the innovative Reference-System. The zero position only has to be set one time: once it is set, the zero remains stored for all further measurements. Therefore, when the indicator is switched ON or the measuring spindle is moved the indicator is immediately ready for measurement; thus the need to reset as with a conventional indicator is now obsolete.

Technical Data

Measuring range		Resolution		Span of error G *	Measuring force	Weight	Order no.
mm	(inch)	mm	inch	mm	N	g	
12.5	(.5")	0.01	/ .0005"	0.020	0.5 - 1	180	4336010
12.5	(.5")	0.005	/ .0001"	0.015	0.5 - 1	180	4336020
12.5	(.5")	0.001	/ .00005"	0.005	0.5 - 1	180	4336030

* in any zero point

Contact Points and Accessories for Dial Indicators, Dial Comparators and Probes

Standard Contact Points 901

Ball dia. 3 mm

Catalog no.		Order no.
901	with steel ball	4360001
901 H	with carbide ball	4360002
901 R	with ruby ball	4360003

Spherical Contact Points 902 Flat Contact Points 903

902	902 H	903	903 H
Steel	Carbide contact face	Steel	Carbide tipped
Length mm	Order no.	Order no.	Order no.
4	4360007	—	4360070
6	4360009	—	4360071
8	4360010	4360040	4360072
10	4360011	4360041	4360073
12	4360012	4360042	4360074
15	4360013	4360043	4360075
20	4360014	4360044	4360076
25	4360015	4360045	4360077
30	4360016	4360046	4360300
35	4360017	4360047	4360078
40	4360019	4360049	4360310
45	4360026	4360050	4360303
50	4360018	4360048	4360079
55	4360031		
65	4360035		
75	4360020		
85	4360036		
95	4360029		

Ball Contact Point 906 H

with carbide ball. accuracy ball dia. 0/-6µm

Ball dia. d mm	l mm	Order no.	Ball dia. d mm	l mm	Order no.
1	8.5	4360150	5.5	9	4360161
1.25	8.5	4360151	6	9	4360162
1.5	8.5	4360152	6.35 (1/4")	9	4360163
1.75	8.5	4360153	6.5	10	4360164
2	8.5	4360154	7	10	4360165
2.5	8.5	4360155	7.5	11	4360166
3	8.5	4360156	8	11	4360167
3.5	8.5	4360157	8.5	12	4360168
4	8.5	4360158	9	12	4360169
4.5	8.5	4360159	10	13	4360170
5	9	4360160			

Contact Rollers 909

Concentricity error 3 µm

	Order no.
Cylindrical Roller	909 A 4360220
Radiused Roller, R = 5 mm	909 B 4360221

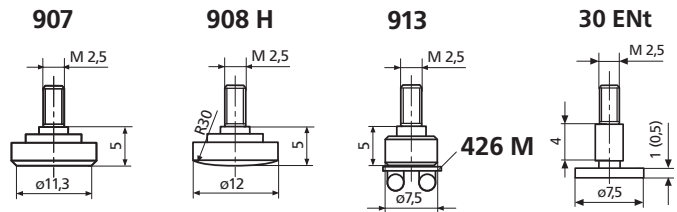
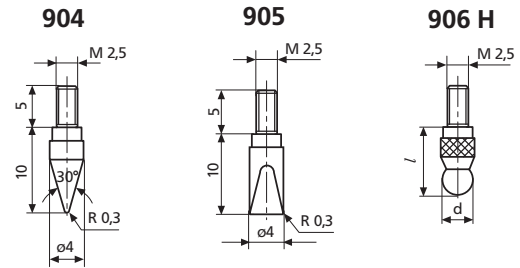
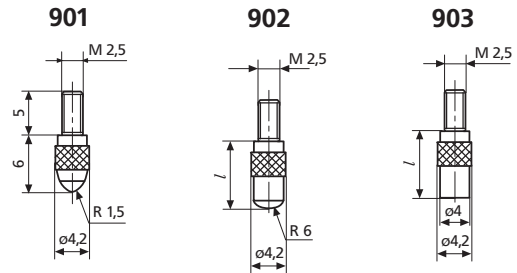

Special Contact Points

	Order no.
Conical Contact Points, Steel	904 4360130
Carbide tipped	904 H 4360131
Wedge Shaped Contact Points, Steel	905 4360140
Carbide tipped	905 H 4360141
Flat Contact Points, Steel, A = 1 cm²	907 4360200
Carbide tipped, dia. 7 mm	907 H 4360201
Spherical Contact Points, Steel	908 4360210
Carbide tipped	908 H 4360211
Flat Contact Point, for mounting	
Pin Gage Holder 426 M for measuring threads using three-wire method	913 4360400
Disc Type anvil thickness 0.5 mm, hardened	30 ENT 4126310
Disc Type anvil thickness 1 mm, hardened	30 ENT 4882022

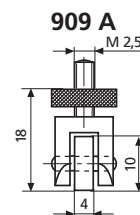

Contact Points and Accessories for Dial Indicators, Dial Comparators and Probes

Measuring Attachment 910 H

	Order no.
with parallel adjustable carbide blades	910 H 4360230

Pin Contact Point 911

dia. 1.5 mm, flat

Length l mm	Order no.	Length l mm	Order no.
15	4360280	35	4360284
20	4360281	40	4360285
25	4360282	50	4360286
30	4360283		

Pin Contact Point 911 H

	Order no.
Carbide tipped, dia 1 mm, flat	911 H1 4360240
Carbide tipped, dia 1.5 mm, flat	911 H2 4360241

Measuring Spindle Extensions 912

Length l mm	Order no.	Length l mm	Order no.
10	4360250	35	4360254
15	4360251	50	4360255
20	4360252	75	4360256
25	4360253	100	4360257

Special Holder 941

For all types of measuring equipment
 For placing a dial indicator at a certain distance or angle
 Travel of the measuring spindle 3 mm
 Contact Point 901 (interchangeable)

Straight Holder 941 G
 Mounting shank length l_1
 mm

Angular Holder 941 W

Order no.	l_2 mm	Order no.	l_2 mm	Order no.	l_2 mm
25	4365000	53.7	35	49.3	34.5
50	4365001		50		
75	4365002		75		

Sensor Level 943

	Order no.
For testing concentricity in bore holes as well as difficult to reach outside diameters To be inserted in a measuring stand with a lifting device Contact Point 901 interchangeable Travel ± 1 mm	4367000

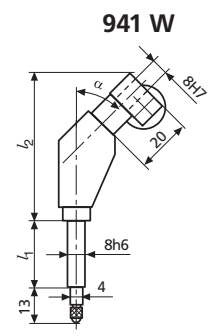
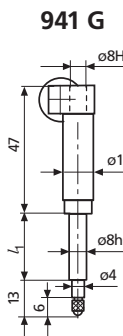
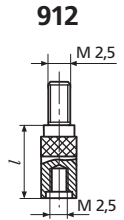
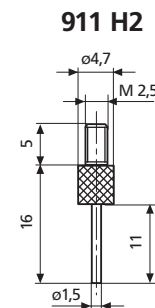
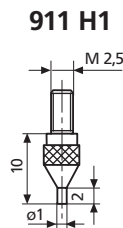
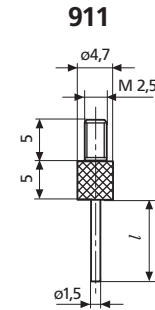
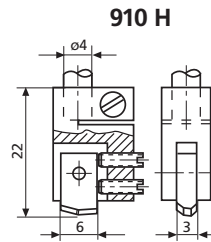

Transmission error with the 941 W
 max. 1%;
 for travel 3 mm = 0.03 mm

