

PRECISION BEGINS AT THE START OF THE MEASURING PROCESS

Air gages use the measuring effect of the change in pressure when a workpiece approaches a measuring jet. As the distance between jets and work surface decreases, the pressure increases while the velocity of flow and the respective volume flow decrease. The air measuring procedure has a relatively short but very linear measuring range.

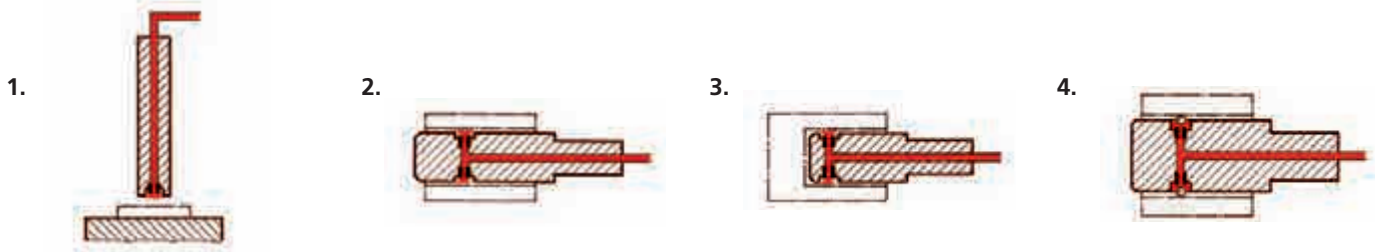

1. Thickness or wall thickness measurements with jet air gage.

2. Diameter measurement of cylindrical through bores with jet air plug gage.

3. Diameter measurement of cylindrical blind bores with jet air plug gage.

4. Diameter measurement of cylindrical through bores with ball contact plug gage.

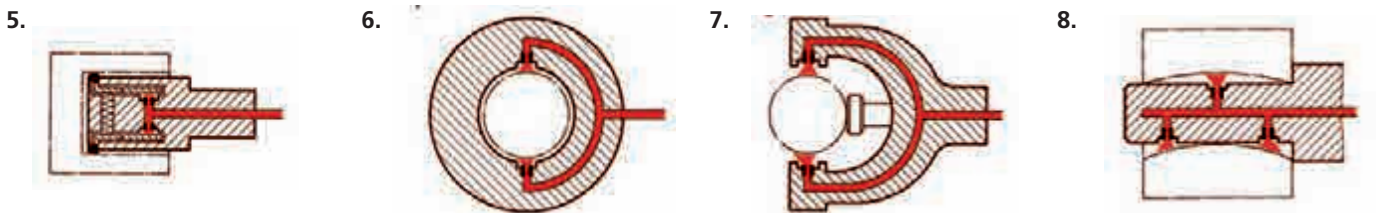

5. Diameter measurement of cylindrical blind bores with lever contact plug gage.

6. Diameter of thickness measurement with adjustable jet air caliper gage.

7. Diameter measurement of cylindrical shafts with jet air ring gage.

8. Straightness measurement of a cylindrical bore with special jet air plug gage.

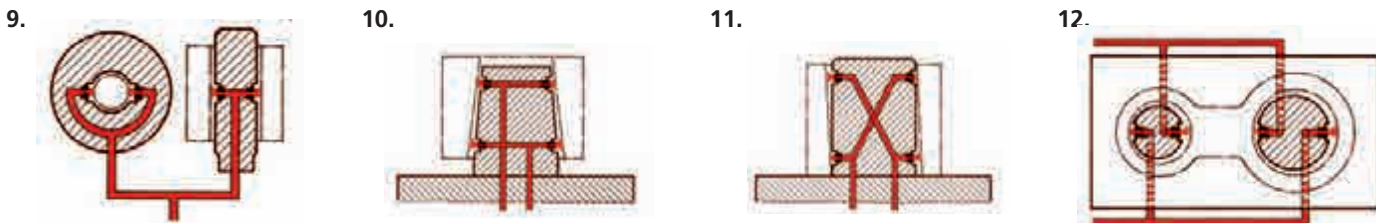

9. Mating measurement between bore and shaft with jet air plug gage and jet air ring gage.

10. Taper pitch measurement of an inside taper with taper jet air plug gage measurement as per the differential measuring method.

11. Measurement of a perpendicular position of a cylindrical bore to the front face with a special jet air plug gage measurement as per the differential measuring method.

12. Measurement of hole distances of separated cylindrical bores with jet air plug gage measurement as per the differential measuring method.

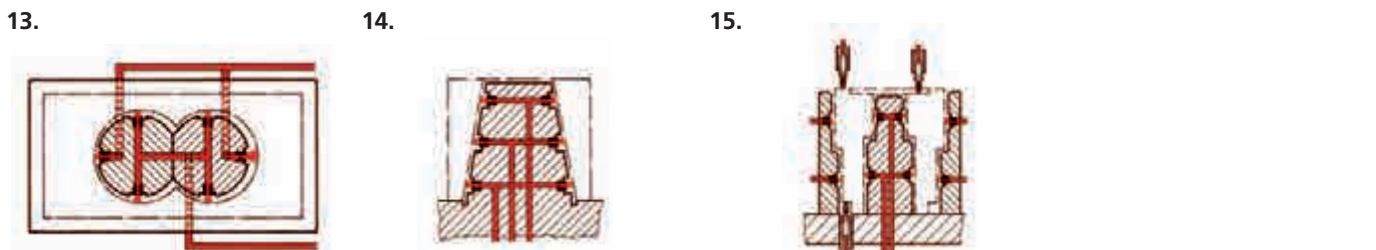

13. Measurement of hole distances of truncated cylindrical bores with jet air plug gages measurement as per the differential measuring method.

14. Taper pitch measurement as well as form and diameter measurement of an inside taper with taper jet air plug gage.

15. Multiple inside and outside measurements with measuring jet air gages and contact probes in connection with a seven-column unit.

Dimensionair® Air Gages — Air Plugs

- Calibrated ID tooling for the Dimensionair® Air Gaging Systems
- Tooling is interchangeable without adjusting system magnification.
- Federal Air Plugs have large

clearance (see table below), allowing easy entrance into the hole being measured and a greater measuring range.

- Long life - wide clearance and

- hard chrome (optional) body extends life of the Air Plug.
- Deep, recessed jets - Air jets are recessed into the plug body, protecting them from damage.
- Large jet size eliminates clogging from dirt and oils.

Plug identification



Air Plugs are marked with an identification number which identifies its size, number of jets, plug style, and the Dimensionair® Model the plug should be used with.

Identification	Nominal Size from		To & include		Clearance from Nominal Size	
	mm	inch	mm	inch	mm	inch
DP20	3	.123"	3.5	.140"	0.009	.00035"
	3.5	.140"	4.7	.185"	0.013	.0005"
	4.7	.185"	6.3	.248"	0.015	.0006"
	6.3	.248"	76.3	3.004"	0.023	.0009"
	76.3	3.004"	127	5.000"	0.071	.0028"
	Above 127	5.000"			0.081	.0032"
DP50	3	.123"	3.5	.140"	0.015	.0006"
	3.5	.140"	4.7	.185"	0.027	.0011"
	4.7	.185"	6.3	.248"	0.030	.0012"
	6.3	.248"	76.3	3.004"	0.045	.0018"
	76.3	3.004"	127	5.000"	0.071	.0028"
	Above 127	5.000"			0.081	.0032"
DP60	3	.123"	3.5	.140"	0.030	.0012"
	3.5	.140"	4.7	.185"	0.045	.0018"
	4.7	.185"	6.3	.248"	0.061	.0024"
	6.3	.248"	76.3	3.004"	0.081	.0032"
	76.3	3.004"	127	5.000"	0.089	.0035"
	above 127	5.000"			0.107	.0042"

For example: DP50-T2-1.000 is the identification number of an Air Plug for a 2095184 or a standard magnification 832 Dimensionair® (DP50), through-hole style with two jets (-T2), and 25 mm/1.000" nominal size (-1.000).

The number (50) which identifies the Dimensionair® intended is marked on the plug and also appears on the dial of the Dimensionair® to help in matching the tooling to its corresponding Dimensionair® Model.

Ordering Information

When ordering Air Plugs please specify:

1. Nominal ID Size and Tolerance.
2. Dimensionair® Model to be used.
3. Air Plug style (Through Hole, Blind Hole, or Counterbore).
4. Air Plug finish (Chrome-plated or Hardened Steel).
5. Please order Master Setting Ring at same time. Unless otherwise specified, Mahr will furnish a 2-jet, Through Hole, High Chrome Air Plug for a 2500:1 Dimensionair®.



Through Hole and Blind Hole Air Plugs

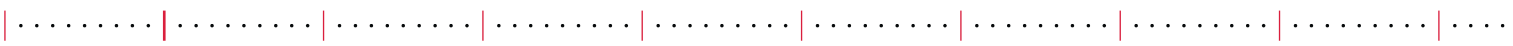

Through and Blind Holes

For air gages, an appropriate setting master according to accuracy grade XX, can be ordered separately.

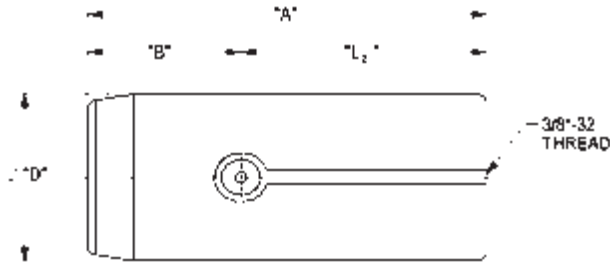

Through Holes

Nominal deviations from - to ø D		A		B		L2		Minimum length of bore		Measuring Range	Order no.	Measuring Range	Order no.	Measuring Range	Order no.
mm	(inch)	mm	(inch)	mm	(inch)	mm	(inch)	mm	(inch)	µm (inch)		µm (inch)		µm (inch)	
3.124 - 3.553	(0.1230 - 0.1399)	23.80	(.937)	4.75	(.187)	19.05	(.750)	4.75	(.187)	13 (.0005)	2092975	25 (.0010)	2092945	51 (.0020)	2108672
3.556 - 4.696	(0.1400 - 0.1849)	23.80	(.937)	4.75	(.187)	19.05	(.750)	4.75	(.187)	19 (.00075)	2092976	38 (.0015)	2092946	76 (.0030)	2108673
4.699 - 6.312	(0.1850 - 0.2485)	38.10	(1.500)	12.70	(.500)	25.40	(1.000)	4.75	(.187)	25 (.0010)	2092977	51 (.0020)	2092947	102 (.0040)	2108674
6.314 - 9.484	(0.2486 - 0.3734)	38.10	(1.500)	12.70	(.500)	25.40	(1.000)	6.35	(.250)	38 (.0015)	2092978	76 (.0030)	2092948	152 (.0060)	2108675
9.487 - 12.494	(0.3735 - 0.4919)	38.10	(1.500)	12.70	(.500)	25.40	(1.000)	6.35	(.250)	38 (.0015)	2092979	76 (.0030)	2092949	152 (.0060)	2108676
12.497 - 13.688	(0.4920 - 0.5389)	38.10	(1.500)	12.70	(.500)	25.40	(1.000)	6.35	(.250)	38 (.0015)	2092980	76 (.0030)	2092950	152 (.0060)	2108677
13.691 - 14.933	(0.5390 - 0.5879)	38.10	(1.500)	12.70	(.500)	25.40	(1.000)	6.35	(.250)	38 (.0015)	2092981	76 (.0030)	2092951	152 (.0060)	2108678
14.935 - 20.978	(0.5880 - 0.8259)	41.28	(1.625)	15.88	(.625)	25.40	(1.000)	6.35	(.250)	38 (.0015)	2092982	76 (.0030)	2092952	152 (.0060)	2108679
20.980 - 28.699	(0.8260 - 1.1299)	41.28	(1.625)	15.88	(.625)	25.40	(1.000)	6.35	(.250)	38 (.0015)	2092983	76 (.0030)	2092953	152 (.0060)	2108680
28.702 - 37.691	(1.1300 - 1.4839)	41.28	(1.625)	15.88	(.625)	25.40	(1.000)	6.35	(.250)	38 (.0015)	2092984	76 (.0030)	2092954	152 (.0060)	2108681
37.694 - 44.193	(1.4840 - 1.7399)	50.80	(2.000)	19.05	(.750)	31.75	(1.250)	6.35	(.250)	38 (.0015)	2092985	76 (.0030)	2092955	152 (.0060)	2108682
44.196 - 63.751	(1.7400 - 2.5099)	50.80	(2.000)	19.05	(.750)	31.75	(1.250)	6.35	(.250)	38 (.0015)	2092986	76 (.0030)	2092956	152 (.0060)	2108683
63.754 - 76.299	(2.5100 - 3.0039)	50.80	(2.000)	19.05	(.750)	31.75	(1.250)	6.35	(.250)	38 (.0015)	2092987	76 (.0030)	2092957	152 (.0060)	2108684
76.302 - 89.151	(3.0040 - 3.5099)	50.80	(2.000)	19.05	(.750)	31.75	(1.250)	6.35	(.250)	38 (.0015)	2092988	76 (.0030)	2092958	152 (.0060)	2108685
89.154 - 104.115	(3.5100 - 4.0990)	50.80	(2.000)	19.05	(.750)	31.75	(1.250)	6.35	(.250)	38 (.0015)	2092989	76 (.0030)	2092959	152 (.0060)	2108686
104.117 - 114.300	(4.0991 - 4.5000)	50.80	(2.000)	19.05	(.750)	31.75	(1.250)	6.35	(.250)	38 (.0015)	2092990	76 (.0030)	2092960	152 (.0060)	2108687

Blind Holes

Nominal deviations from - to ø D		A		B		L2		Minimum length of bore		DP20 (5000:1)		DP50 (2500:1)		DP60 (1250:1)	
mm	(inch)	mm	(inch)	mm	(inch)	mm	(inch)	mm	(inch)	µm (inch)		µm (inch)		µm (inch)	
3.937 - 4.696	(0.1550 - 0.1849)	19.05	(.750)	3.96	(.156)	15.09	(.594)	6.35	(.250)	19 (.00075)	2092991	38 (.0015)	2092961	76 (.0030)	2108688
4.699 - 6.312	(0.1850 - 0.2485)	29.36	(1.156)	3.96	(.156)	25.40	(1.000)	6.35	(.250)	25 (.0010)	2092992	51 (.0020)	2092962	102 (.0040)	2108689
6.314 - 9.484	(0.2486 - 0.3734)	29.36	(1.156)	3.96	(.156)	25.40	(1.000)	6.35	(.250)	38 (.0015)	2092993	76 (.0030)	2092963	152 (.0060)	2108690
9.487 - 11.859	(0.3735 - 0.4669)	29.36	(1.156)	3.96	(.156)	25.40	(1.000)	6.35	(.250)	38 (.0015)	2092994	76 (.0030)	2092964	152 (.0060)	2108691
11.862 - 14.933	(0.4670 - 0.5879)	29.36	(1.156)	3.96	(.156)	25.40	(1.000)	6.35	(.250)	38 (.0015)	2092995	76 (.0030)	2092965	152 (.0060)	2108692
14.935 - 20.978	(0.5880 - 0.8259)	29.36	(1.156)	3.96	(.156)	25.40	(1.000)	6.35	(.250)	38 (.0015)	2092996	76 (.0030)	2092966	152 (.0060)	2108693
20.980 - 28.699	(0.8260 - 1.1299)	29.36	(1.156)	3.96	(.156)	25.40	(1.000)	6.35	(.250)	38 (.0015)	2092997	76 (.0030)	2092967	152 (.0060)	2108694
28.702 - 37.691	(1.1300 - 1.4839)	29.36	(1.156)	3.96	(.156)	25.40	(1.000)	6.35	(.250)	38 (.0015)	2092998	76 (.0030)	2092968	152 (.0060)	2108695
37.694 - 44.193	(1.4840 - 1.7399)	35.71	(1.406)	3.96	(.156)	31.75	(1.250)	6.35	(.250)	38 (.0015)	2092999	76 (.0030)	2092969	152 (.0060)	2108696
44.196 - 63.751	(1.7400 - 2.5099)	35.71	(1.406)	3.96	(.156)	31.75	(1.250)	6.35	(.250)	38 (.0015)	2093000	76 (.0030)	2092970	152 (.0060)	2108697
63.754 - 76.299	(2.5100 - 3.0039)	35.71	(1.406)	3.96	(.156)	31.75	(1.250)	6.35	(.250)	38 (.0015)	2093001	76 (.0030)	2092971	152 (.0060)	2108698
76.302 - 89.151	(3.0040 - 3.5099)	38.10	(1.500)	3.96	(.156)	34.14	(1.344)	6.35	(.250)	38 (.0015)	2093002	76 (.0030)	2092972	152 (.0060)	2108699
89.154 - 101.851	(3.5100 - 4.0099)	38.10	(1.500)	3.96	(.156)	34.14	(1.344)	6.35	(.250)	38 (.0015)	2093003	76 (.0030)	2092973	152 (.0060)	2108700
101.854 - 114.300	(4.0100 - 4.5000)	38.10	(1.500)	3.96	(.156)	34.14	(1.344)	6.35	(.250)	38 (.0015)	2093004	76 (.0030)	2092974	152 (.0060)	2108701

Through Hole Plugs (DP50 – DP20)

3.94-4.70 mm / .155-.185"

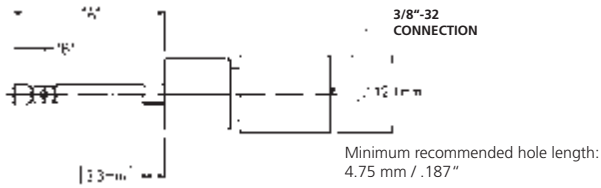

11.86-14.94 mm / .467-.588"

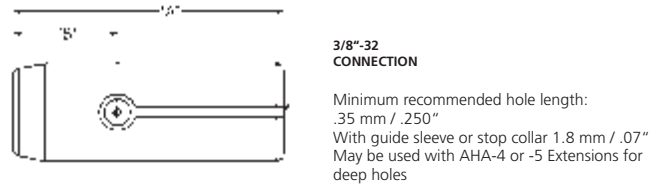

4.70-6.30 mm / .185-.248"

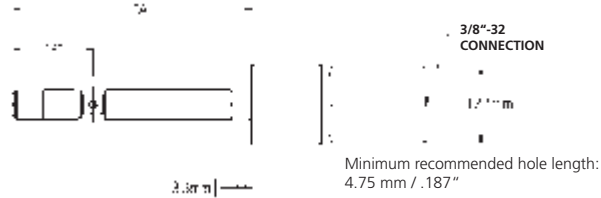

14.94-37.69 mm / .588-1.484"

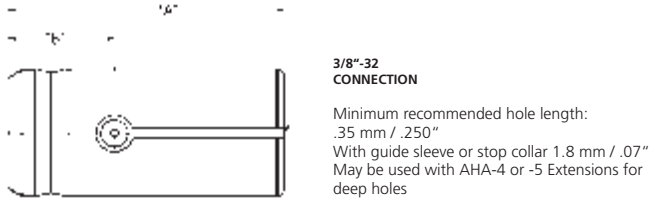

6.30-9.49 mm / .248-.3735"

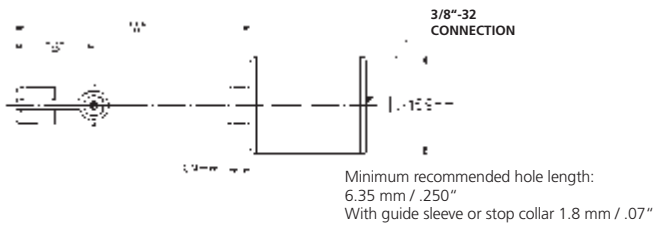

37.69-76.30 mm / 1.484-3.004"

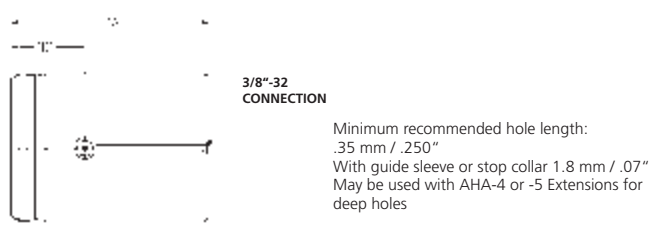

9.49-11.86 mm / .3735-.467"

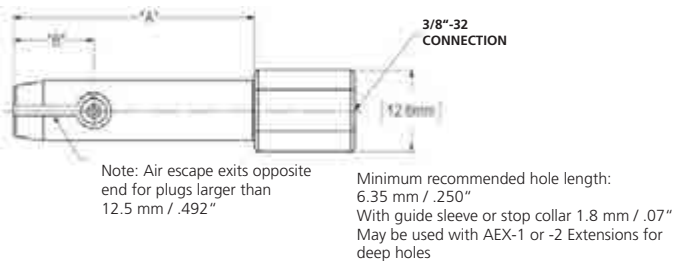

76.30-114.30 mm / 3.004-4.500"

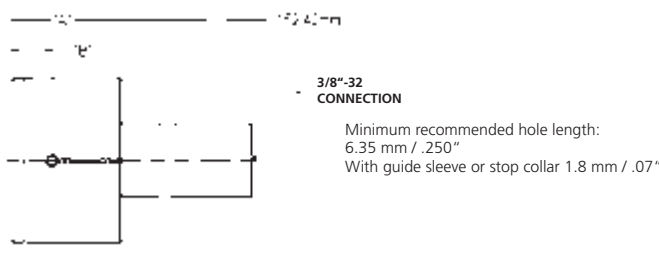

Nominal Dimension mm / inch				Minimum Hole Length*		Measuring range		
Including & Above	To	"A"	"B"	mm	inch	DP20	DP50	DP60
3.12 / .123"	3.56 / .140"	23.81 / .938"	4.76 / .188"	4.75 / .187"	.013 / .0005"	.025 / .0010"	.051 / .0020"	
3.56 / .140"	4.70 / .185"	23.81 / .938"	4.76 / .188"	4.75 / .187"	.0200 / .00075"	.038 / .0015"	.076 / .0030"	
4.70 / .185"	6.30 / .248"	38.10 / 1.500"	12.70 / .500"	4.75 / .187"	.025 / .0010"	.051 / .0020"	.102 / .0040"	
6.30 / .248"	9.49 / .3735"	38.10 / 1.500"	12.70 / .500"	6.35 / .250"	.038 / .0015"	.076 / .0030"	.152 / .0060"	
9.49 / .3735"	14.94 / .588"	38.10 / 1.500"	12.70 / .500"	6.35 / .250"	.038 / .0015"	.076 / .0030"	.152 / .0060"	
14.94 / .588"	19.05 / .750"	41.28 / 1.625"	15.88 / .625"	6.35 / .250"	.038 / .0015"	.076 / .0030"	.152 / .0060"	
19.05 / .750"	37.69 / 1.484"	41.28 / 1.625"	15.88 / .625"	6.35 / .250"	.038 / .0015"	.076 / .0030"	.152 / .0060"	
37.69 / 1.484"	76.30 / 3.004"	50.80 / 2.000"	19.10 / .750"	6.35 / .250"	.038 / .0015"	.076 / .0030"	.152 / .0060"	
76.30 / 3.004"	114.30 / 4.500"	50.80 / 2.000"	19.10 / .750"	6.35 / .250"	.038 / .0015"	.076 / .0030"	.152 / .0060"	

* If a guide sleeve or stop collar is used, minimum hole length can be as small as 1.78 mm / .070" for holes larger than 6.30 mm / .248".

** A handle 152 mm / 6" long and 33.3 mm / 1.31" diameter is supplied with plugs over 76.30 mm / 3.004".

Blind Hole / Counterbore Plugs (DP50 – DP20)

3.94-4.70 mm / .155-.185"

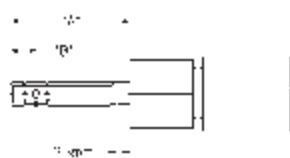

3/8"-32
CONNECTION

Minimum recommended hole length: 6.35 mm / .250"
Note: Masters must simulate workpiece for holes of this size

11.86-14.94 mm / .467-.588"

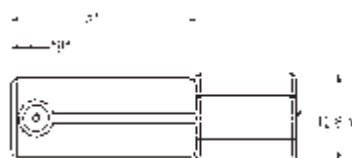

3/8"-32
CONNECTION

Minimum recommended hole length: 6.35 mm / .250"
May be used with Extensions 2201963 and 2201954

4.70-6.30 mm / .185-.248"

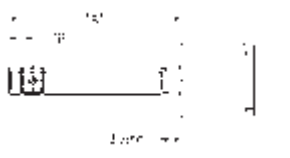

3/8"-32
CONNECTION

Minimum recommended hole length: 6.35 mm / .250"

14.94-37.69 mm / .588-1.484"

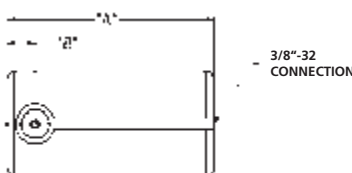

3/8"-32
CONNECTION

Minimum recommended hole length: 6.35 mm / .250"
May be used with Extensions 2202010 and 2202011

6.30-9.49 mm / .248-.3735"

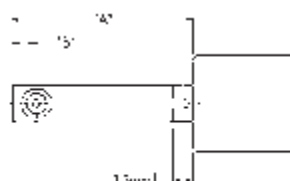

3/8"-32
CONNECTION

Minimum recommended hole length: 6.35 mm / .250"

37.69-76.30 mm / 1.484-3.004"

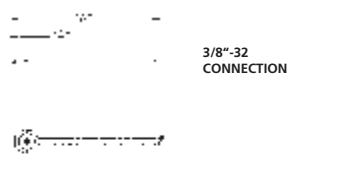

3/8"-32
CONNECTION

Minimum recommended hole length: 6.35 mm / .250"
May be used with Extensions 2202010 and 2202011

9.49-11.86 mm / .3735-.467"

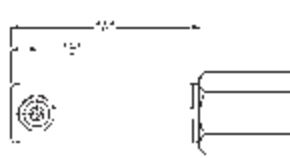

3/8"-32
CONNECTION

Minimum recommended hole length: 6.35 mm / .250"
May be used with Extension 2202009

76.30-114.30 mm / 3.004-4.500"

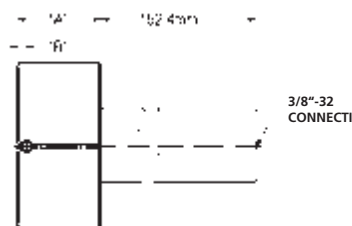

3/8"-32
CONNECTION

Super-blind Plugs

Blind Hole Air Plugs can be furnished to check shorter holes than listed above, and can be furnished to check closer to the bottom of a hole. Holes must be at least 2.79 mm/.110" long, and the

distance from the end of the plug to the center-line of the jets can be as short as 2.16 mm/.075" for plugs below 6.34 mm/.250" or 2.16 mm/.095" for plugs above 6.34 mm/.250".

Nominal Dimension mm / inch		Minimum Hole Length*		Measuring range			
Including & Above	To	"A"	"B"	mm / inch	DP20	DP50	DP60
3.94 / .155"	4.70 / .185"	19.10 / .750"	3.96 / .156"	6.35 / .250"	.0200 / .00075"	.038 / .0015"	.076 / .0030"
4.70 / .185"	6.30 / .248"	29.36 / 1.156"	3.96 / .156"	6.35 / .250"	.025 / .0010"	.051 / .0020"	.102 / .0040"
6.30 / .248"	9.49 / .3735"	29.36 / 1.156"	3.96 / .156"	6.35 / .250"	.038 / .0015"	.076 / .0030"	.152 / .0060"
9.49 / .3735"	11.86 / .467"	29.36 / 1.156"	3.96 / .156"	6.35 / .250"	.038 / .0015"	.076 / .0030"	.152 / .0060"
11.86 / .467"	14.94 / .588"	29.36 / 1.156"	3.96 / .156"	6.35 / .250"	.038 / .0015"	.076 / .0030"	.152 / .0060"
14.94 / .588"	37.69 / 1.484"	29.36 / 1.156"	3.96 / .156"	6.35 / .250"	.038 / .0015"	.076 / .0030"	.152 / .0060"
37.69 / 1.484"	76.30 / 3.004"	35.71 / 1.406"	3.96 / .156"	6.35 / .250"	.038 / .0015"	.076 / .0030"	.152 / .0060"
76.30 / 3.004"	114.30 / 4.500"	38.10 / 1.500"	3.96 / .156"	6.35 / .250"	.038 / .0015"	.076 / .0030"	.152 / .0060"

* If a guide sleeve or stop collar is used, minimum hole length can be as small as 1.78 mm / .070" for holes larger than 6.30 mm / .248".

** A handle 152 mm / 6" long and 33.3 mm / 1.31" diameter is supplied with plugs over 76.30 mm / 3.004".

Dimensionair® Air Rings

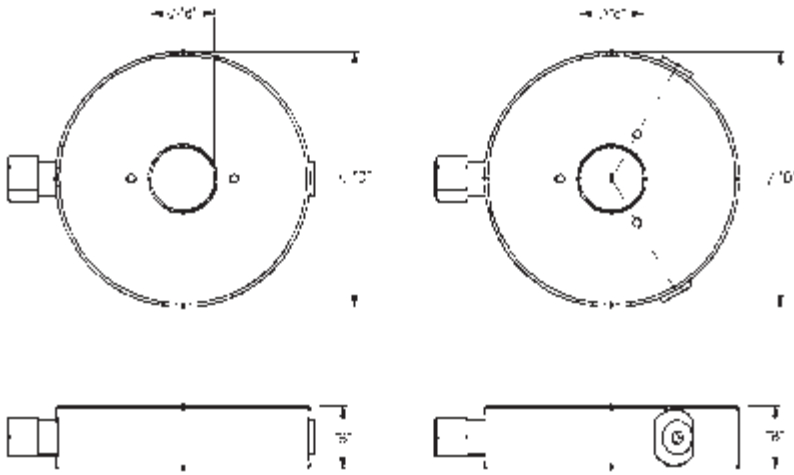

For applications where OD's need to be checked near a shoulder, or where part length is restricted, contact Mahr Federal for technical assistance about shoulder and Snout Type Air Rings.

For every air gage, an appropriate setting master can be ordered.

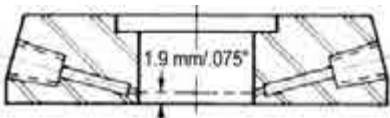

Shoulder Type
(for 2500:1 & 4000:1
5000:1 & 8000:1 only)

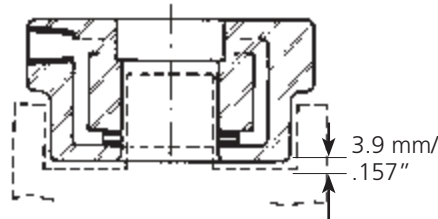

Snout Types

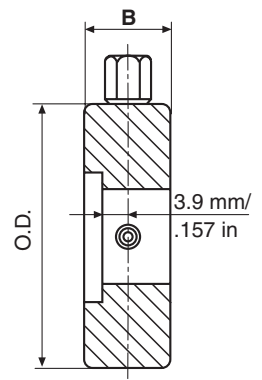

Counterbore Type

Nominal deviations from - to dia. D mm (inch)			2 Measuring Jets Measuring Range/type		3 Measuring Jets Measuring Range/type	
ϕD mm (inch)	B mm (inch)	38 μm (.0015") DR 20 5000:1	76 μm (.003") DR 50 2500:1	38 μm (.0015") DR 20-3 5000:1	76 μm (.003") DR 50-3 2500:1	
6.299 - 7.592 (0.2480 - 0.2989)	76.20 (3.000)	25.40 (1.000)	2093025	2093005	2093035	2093015
7.595 - 9.294 (0.2990 - 0.3659)	76.20 (3.000)	25.40 (1.000)	2093026	2093006	2093036	2093016
9.296 - 13.002 (0.3660 - 0.5119)	76.20 (3.000)	25.40 (1.000)	2093027	2093007	2093037	2093017
13.005 - 21.003 (0.5120 - 0.8269)	76.20 (3.000)	25.40 (1.000)	2093028	2093008	2093038	2093018
21.006 - 25.400 (0.8270 - 1.0000)	76.20 (3.000)	25.40 (1.000)	2093029	2093009	2093039	2093019
25.403 - 38.351 (1.0001 - 1.5099)	101.60 (4.000)	25.40 (1.000)	2093030	2093010	2093040	2093020
38.354 - 44.450 (1.5100 - 1.7500)	101.60 (4.000)	25.40 (1.000)	2093031	2093011	2093041	2093021
44.453 - 50.797 (1.7501 - 1.9999)	127.00 (5.000)	25.40 (1.000)	2093032	2093012	2093042	2093022
50.800 - 63.500 (2.0000 - 2.5000)	127.00 (5.000)	25.40 (1.000)	2093033	2093013	2093043	2093023

Setting Standards for indicating measuring instruments

AGD Masters



Master Rings

- Traceable certification and calibration available on request.
- Polished and lapped to size
- Non-gaging areas black oxidized — ring faces ground.
- Meet all requirements of ANSI Specification B47.1-1988
- Manufactured in accordance with ANSI Specification B89.1.6-1984.

Master Discs AGD Style 3

- Traceable certification and calibration available on request.
- Polished and lapped to size
- Non-gaging areas black oxidized — ring faces ground.
- Meet all requirements of ANSI Specification B47.1-1988

Master Plugs

- Traceable certification and calibration available on request.
- Stabilized and hardened.
- 100 % usable gaging surface.
- Ends ground square
- Lapped finish.

- Manufactured in accordance with ANSI Specification B89.1.5.
- Furnished with clear insulators.
- All dimensions are AGD style 3.

Accessories Air Gaging Instruments

Handles and Extensions

When an Air Plug is used with a hose, it should be equipped with a Handle to avoid excessive strain on the air connection and corrosion on the polished plug body. Handles may be combined for gaging deep holes.

Selection of a handle or extension is determined by the bore itself and whether or not it is preceded by a larger C-bored diameter. Corresponding thread sizes of the handle or extension must also be considered.

If no portion of the handle or extension enters the part, only thread sizes must be considered. If the plug does enter the part, then both O.D. and thread size must be considered.

2202010 and 2202011 Extensions — accepts Hose 2202074 on one end and the following plug sizes on the opposite end: all 8000:1 plugs up to 76.3 mm / 3.004”.

2202012 Handle — accepts Hose 2202074 on one end and the following plug sizes on the opposite end: all 8000:1 plugs up to 76.3 mm / 3.004”.
Has Bakelite insulating cover. Recommended for 37.7 mm / 1.484” up to 76.3 mm / 3.004” diameters.

2237666 — High impact and coolant resistant, lightweight composite handle — normally furnished with μ Dimensionair® and air snaps

2093045 — lightweight aluminum handles with or without air shutoff valve.

2202003 Handle — used and furnished with 1250:1 thru 8000:1 through or blind hole plugs over 76.3 mm / 3.004”.

2202009 Handle — Used with 2500:1 thru 8000:1 blind hole plugs in the 9.47 mm / .3735” to 11.8 mm / .467” range, using an Adaptor 2201588.

2201954 and 2201963 Extensions — used with 2500:1 thru 8000:1 through hole air plugs in the 9.47 mm / .3735” to 14.93 mm / .588” range and with 11.8 mm / .467” to 14.93 mm / .588” range blind hole plugs, using an Adaptor 2201601.

2201975 — extension used with an Adjustable Base 2204599. Provides easily configured base for bench mounted air tooling fixturing

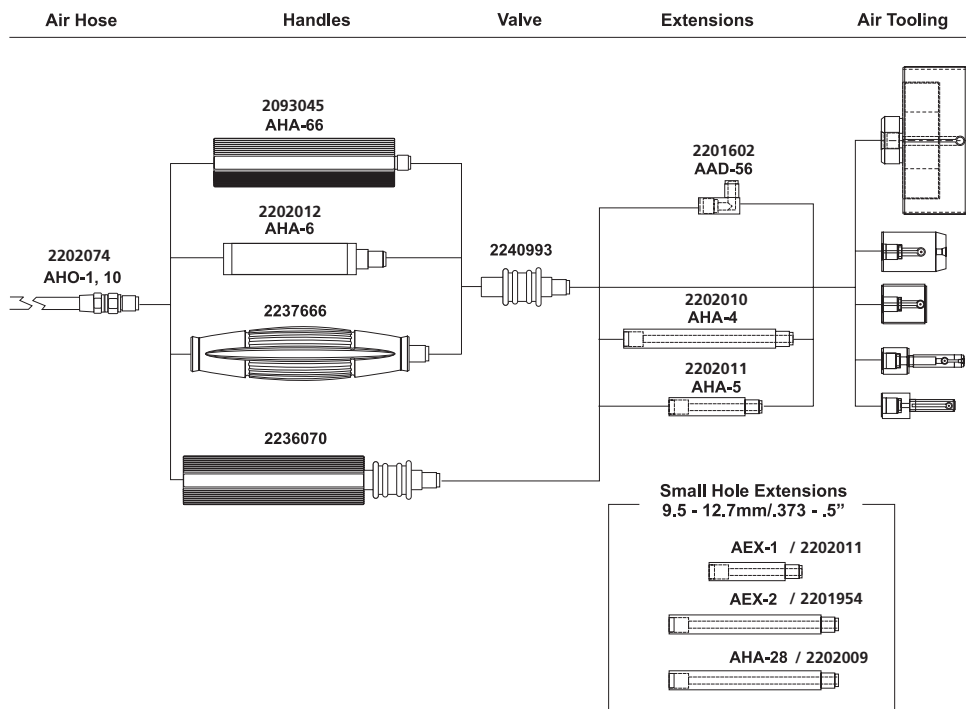

Thread	ø		Length		Order no.
	mm	/ inch	mm	/ inch	
3/8-32	12.07	/.475"	102	/ 4"	2202010
3/8-32	12.07	/.475"	51	/ 2"	2202011
3/8-32	19	/.750"	102	/ 4"	2202012
1-1/8-18	33.4	/ 1.315"	152	/ 6"	2202003
3/8-32	12.7	/.500"	133.3	/ 5.25"	2202006
10-32	9.14	/.360"	102	/ 4"	2202009
5/16-32	9.02	/.355"	51	/ 2"	2201954
5/16-32	9.02	/.355"	102	/ 4"	2201963
3/8-32	9.5	/.374"	61.7	/ 2.43"	2201975*

* Use on 2204599

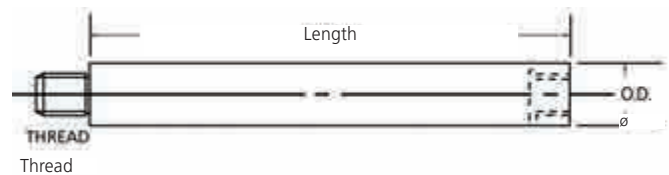

Single Jet Probe Millimar AAT-19 / AAT-20

- JetProbes and provide modular, convenient gage heads for use in hand-held gages and for designing into fixture gages
- 9.5 mm / .375" bodies provide standardized mounting configurations
- Compact size allows easy access to hard-to-reach dimensions
- JetProbes and are calibrated for instant use with Dimensionair® systems - just set zero and measure!
- Available in single-probe and matched-probe configurations
- JetProbes are similar to AirProbes, except they have an open jet at the end, instead of a contacting spindle.
- JetProbes are ideal for measuring flatness of surfaces which cannot be touched, or for building into fixture designs where air gaging is called for.
- JetProbes can be used with 2500:1, 5000:1 Dimensionair®, and are supplied singly or in matched pairs. Order no. AAT-19 for single JetProbe or AAT-20 for a matched pair.
- JetProbes are supplied with AHO-1 Air Hose, a zero setting valve, and hardware for mounting to the Dimensionair®.



Technical Data

Order no.	2086612	2086613
Product type	AAT-19	AAT-20
Magnification	2500:1	
Design	Single jet probe	Matched jet probe pair

Willrich Precision Instrument Company
 Ph 866-945-5742
sales@willrich.com