

# 301 SERIES DIRECT READING MIN-WALL/THICKNESS GAGES

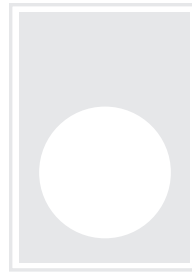
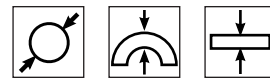

## Maximum Measuring Accuracy

301 Series with 3.15" reach  
Linear Accuracy at 0.040" Travel  
≤ 0.0005"/0.010 mm  
Repeatability ≤ 0.0004" (0.010 mm)

Five different contact tip sets available as standard. Fast service on custom arms and contact tips. Contact Dyer office.

## Notable Features

- Operator friendly, no operator error.
- Fast, accurate, repeatable and shop-rugged.
- Gage will reach over flanges and measure hard-to-reach thicknesses on castings and aircraft parts.
- 1-5 day service on custom arms and contacts.
- Easy to read dial.

*We will customize special arms, contact and carbide ball sizes to meet your applications needs.*

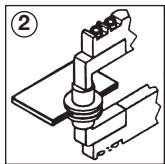

Ø 10.0 mm (0.394") dia.  
flat upper and lower  
upper contact swivels  
lower contact fixed

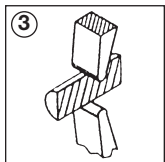

R 0.4 mm (0.016")  
chisel upper and lower

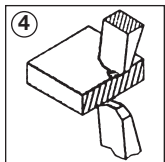

Ø 1.5 mm (0.06")  
ball upper and lower

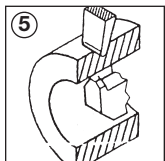

R 0.4 mm (0.016")  
chisel upper arm  
Ø 1.5 (0.059") dia.  
ball lower arm  
straight lower arm

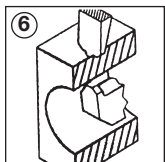

Ø 1.5 mm (0.06")  
C. ball upper and lower  
straight lower arm



Model 301-304



Model 301-306

## Models and Specifications

Application Range	Length L	Dim A	Dim B	Contact Point Type	Graduation	Order Number
<b>Inch Specifications</b>						
0-0.8"	3.15"	1.11"	0.81"	2	0.0005"	<b>301-302</b>
0-0.8"	3.15"	0.97"	0.97"	3	0.0005"	<b>301-303</b>
0-0.8"	3.15"	0.97"	0.97"	4	0.0005"	<b>301-304</b>
0-0.8"	3.15"	0.97"	0.1"	5	0.0005"	<b>301-305</b>
0-0.8"	3.15"	0.97"	0.1"	6	0.0005"	<b>301-306</b>
<b>Metric Specifications (mm)</b>						
0-20 mm	80 mm	28.2 mm	20.7 mm	2	0.010	<b>301-402</b>
0-20 mm	80 mm	24.6 mm	24.6 mm	3	0.010	<b>301-403</b>
0-20 mm	80 mm	24.6 mm	24.6 mm	4	0.010	<b>301-404</b>
0-20 mm	80 mm	24.6 mm	2.5 mm	5	0.010	<b>301-405</b>
0-20 mm	80 mm	24.6 mm	2.5 mm	6	0.010	<b>301-406</b>