

ISO 10664:2014(E)

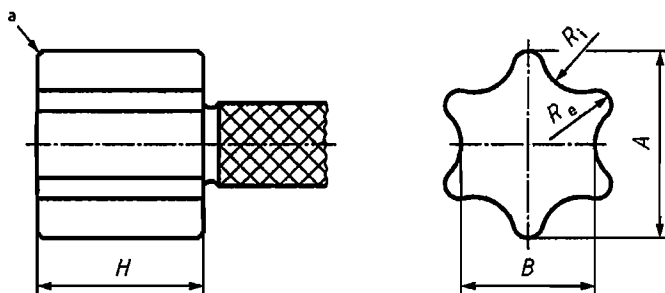

a Radius max. 0,076 mm at juncture of side and face to gauge sizes \geq no. 10 and max. 0,025 4 mm for gauge sizes $<$ no. 10.

Figure 3 — Dimensions of GO gauge

Table 3 — Limiting sizes of GO gauge dimensions

Dimensions in millimetres

Socket no.	A		B		R_i		R_e		H	
	min.	max.	min.	max.	min.	max.	min.	max.	min.	max.
1	0,841	0,855	0,592	0,607	0,198	0,204	0,055	0,062	0,64	1,14
2	0,953	0,967	0,674	0,688	0,221	0,227	0,065	0,072	1,15	1,65
3	1,131	1,145	0,800	0,815	0,263	0,270	0,078	0,085	1,15	1,65
4	1,291	1,305	0,912	0,927	0,305	0,312	0,087	0,093	1,15	1,65
5	1,415	1,430	1,013	1,028	0,318	0,342	0,107	0,111	1,15	1,65
6	1,695	1,709	1,210	1,224	0,371	0,396	0,130	0,134	1,33	1,82
7	2,012	2,026	1,437	1,453	0,442	0,450	0,157	0,165	2,54	3,05
8	2,335	2,349	1,672	1,686	0,498	0,523	0,188	0,193	2,54	3,05
9	2,520	2,534	1,809	1,823	0,542	0,566	0,204	0,210	2,79	3,30
10	2,761	2,776	1,979	1,993	0,585	0,609	0,227	0,231	3,05	3,56
15	3,295	3,309	2,353	2,367	0,704	0,728	0,265	0,269	3,30	3,81
20	3,879	3,893	2,764	2,778	0,846	0,871	0,303	0,307	3,56	4,07
25	4,451	4,465	3,170	3,185	0,907	0,932	0,371	0,378	3,94	4,45
27	5,009	5,024	3,564	3,578	1,095	1,120	0,387	0,393	4,19	4,70
30	5,543	5,557	3,958	3,972	1,182	1,206	0,448	0,454	4,44	4,95
40	6,673	6,687	4,766	4,780	1,415	1,440	0,544	0,548	5,08	5,59
45	7,841	7,856	5,555	5,570	1,784	1,808	0,572	0,576	5,71	6,22
50	8,857	8,872	6,366	6,380	1,804	1,828	0,773	0,777	5,97	6,48
55	11,245	11,259	7,930	7,945	2,657	2,682	0,765	0,769	6,22	6,73
60	13,302	13,317	9,490	9,504	2,871	2,895	1,065	1,069	7,68	8,17
70	15,588	15,603	11,085	11,099	3,465	3,489	1,192	1,196	8,46	8,96
80	17,619	17,635	12,646	12,661	3,625	3,629	1,524	1,529	9,4	9,9
90	20,021	20,035	14,232	14,246	4,456	4,480	1,527	1,534	10,06	10,56
100	22,231	22,245	15,820	15,834	4,913	4,937	1,718	1,724	10,85	11,35

3.3 NO GO gauge

3.3.1 Gauging the fallaway of dimensions A and R_e

The NO GO gauge for dimensions A and R_e (see Figure 4) shall have dimensions within the limits specified in Table 4.

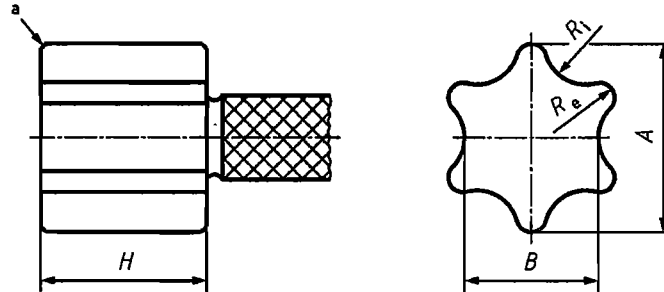

- a Radius max. 0,076 mm at juncture of side and face for gauge sizes \geq no. 10 and max. 0,025 4 mm for gauge sizes $<$ no. 10.

Figure 4 — NO GO gauge for dimensions A and R_e

Table 4 — Limiting sizes of dimensions of NO GO gauge for dimensions A and R_e

Dimensions in millimetres

Socket no.	A		B	R_i		R_e		H
	min.	max.	max.	min.	max.	min.	max.	$\pm 0,25$
1	0,899	0,907	0,587	0,107	0,114	0,084	0,094	0,89
2	1,011	1,019	0,663	0,124	0,132	0,094	0,104	1,4
3	1,214	1,222	0,790	0,137	0,145	0,119	0,130	1,4
4	1,374	1,382	0,917	0,180	0,191	0,132	0,140	1,4
5	1,499	1,506	1,044	0,208	0,221	0,147	0,157	1,4
6	1,778	1,785	1,181	0,231	0,241	0,173	0,180	1,57
7	2,096	2,103	1,359	0,259	0,267	0,203	0,211	2,8
8	2,419	2,425	1,664	0,360	0,370	0,231	0,238	2,79
9	2,604	2,611	1,664	0,323	0,333	0,248	0,257	3,05
10	2,845	2,852	1,956	0,431	0,441	0,269	0,276	3,3
15	3,379	3,385	1,956	0,398	0,408	0,307	0,315	3,56
20	3,963	3,970	2,616	0,602	0,614	0,345	0,353	3,81
25	4,560	4,566	2,868	0,637	0,647	0,429	0,436	4,19
27	5,118	5,126	3,275	0,735	0,747	0,445	0,452	4,45
30	5,652	5,659	3,886	0,939	0,949	0,505	0,513	4,7
40	6,807	6,814	4,661	1,112	1,125	0,612	0,619	5,33
45	7,976	7,983	4,661	1,110	1,123	0,640	0,648	5,97
50	8,992	8,999	6,413	1,628	1,640	0,840	0,848	6,22
55	11,405	11,412	7,684	2,176	2,189	0,845	0,853	6,48
60	13,488	13,495	7,684	2,153	2,164	1,158	1,165	7,92
70	15,774	15,781	10,262	2,545	2,557	1,285	1,292	8,71
80	17,831	17,838	11,760	2,608	2,621	1,628	1,635	9,52